

Test Probes

Altech offers the proper test probe for every specific application. Due to small dimensions in electronic devices, test probes need to be very precise. The Test probes on the following pages meet these high standards.

- Slim and compact body for easy access
- Stainless steel tips
- Spring-loaded tips guarantee contact without damaging test object
- Suitable for testing through oxidation and insulation layers

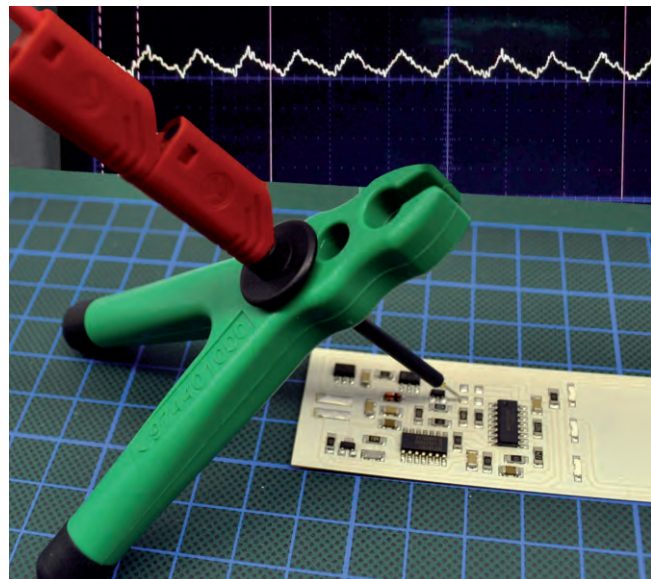
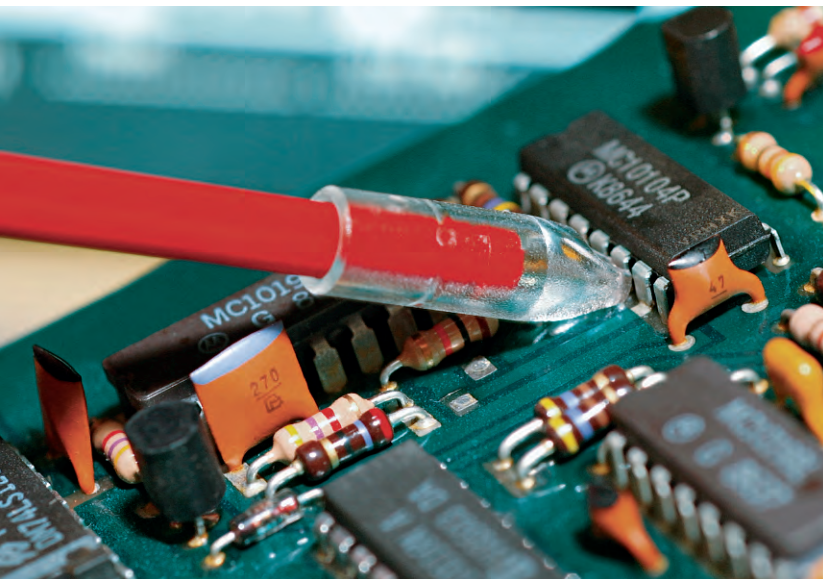
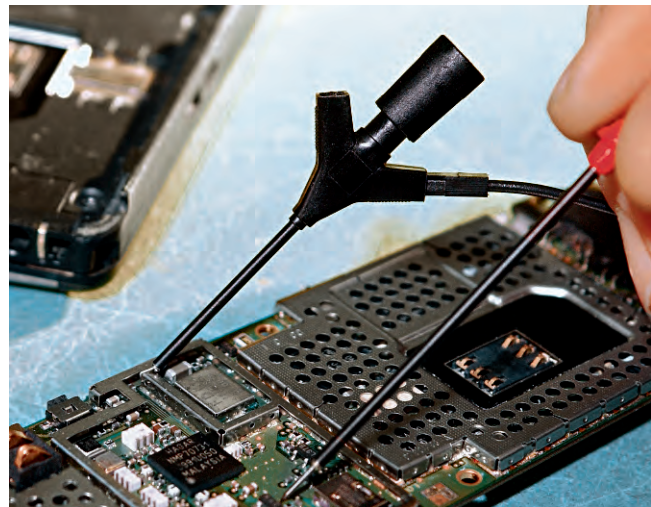

Test Probes 2 mm System



Type

MICRO-PRUEF MPS 2 0,64 FT

Miniature test probe with spring loaded stainless steel probe tip for sampling extremely small measuring points and SMD components. Because the probe tip is sprung, it cannot slip off and provides constant pressure. Connects with MKL 0.64/25-0.25 and MAL N 4-0.64/100-0.25.

Tip diameter 0.75 mm (0.029 in.)

PART NO. / Housing color
973995100 ●
973995101 ●



PRUEF 1

Miniature test probe for sampling extremely small measuring points. Shatter-proof grip, may be unscrewed. The stainless steel tip easily penetrates insulation and oxide layers. Solder connection up to 0.5 mm².

1 mm (0.039 in.)

931376100 ●
931376101 ●

Technical Data

Connection Type spring-loaded tip
 Voltage Rating fixed pin Ø 0.64 mm
 Measurement Category (IEC61010) 30 VAC / 60 VDC
 Current Rating* CAT I
 Contact Resistance 1 A

Material Specifications

Tip stainless steel
 Connection pin/ socket nickel plated brass
 Contact Spring -
 Housing PBT

Environmental Conditions

Temperature range -25 °C to +80 °C (13°F to 176°F)

Flamability Rating

Housing UL 94 HB

stationary tip
 solder connection up to 0.5 mm²
 30 VAC / 60 VDC
 CAT I
 1 A

stainless steel
 nickel plated brass
 -
 PVC-P

-25 °C to +60 °C (13°F to 140°F)

Drawing

Measurements are shown in millimeters.
 Multiply by 0.03937 to convert to inches.

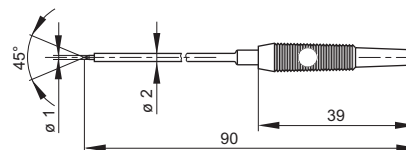
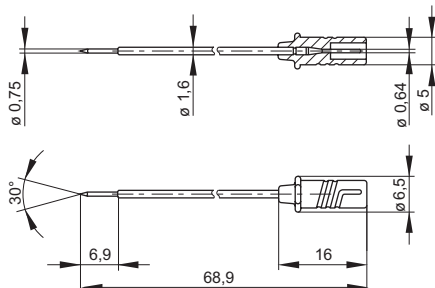

* Please consider derating graph on page 80.

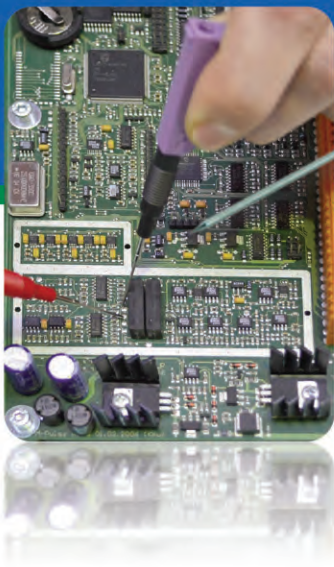

Test Probes 2 mm System



Type

MPS 1

Miniature test probe for sampling very small measuring points. The stainless steel tip easily penetrates insulation and oxide layers. Socket connection through a 2 mm diameter gold-plated socket with contact spring.

PRUEF 1610 FT Au

Safety test probe with shatter-proof insulated sleeve, spring-loaded and slender stainless steel tip. 2 mm diameter gold-plated brass socket connection, stackable with 2 mm safety measuring lead MVL S WS. Insulation and oxide layers can be penetrated by this test probe.

PRUEF 1600 Au

Safety test probe with shatter-proof insulated sleeve and slender stainless steel tip. 2 mm diameter gold-plated brass socket connection, stackable with 2 mm safety measuring lead MVL S WS. Insulation and oxide layers can be penetrated by this test probe.

Tip diameter

1 mm (0.039 in.)

0.75 mm (0.029 in.)

1.4 mm (0.055 in.)

PART NO. / Housing color

973531100 ●
973531101 ●

975018700 ●
975018701 ●

975017700 ●
975017701 ●

Technical Data

Connection Type	stationary tip
Voltage Rating	spring-loaded socket Ø 2 mm
Measurement Category (IEC61010)	30 VAC / 60 VDC
Current Rating*	CAT I
Contact Resistance	1 A
Material Specifications	100 mOhm
Tip	stainless steel
Connection pin/ socket	gold plated copper-beryllium
Contact Spring	-
Housing	PE
Environmental Conditions	
Temperature range	-25 °C to +60 °C (13°F to 140°F)
Flamability Rating	
Housing	-

Connection Type	spring-loaded tip
Voltage Rating	fixed socket Ø 2mm
Measurement Category (IEC61010)	AC/DC 1000V
Current Rating*	CAT II
Contact Resistance	10 A
Material Specifications	20 mOhm
Tip	stainless steel
Connection pin/ socket	gold plated copper-beryllium
Contact Spring	-
Housing	PA
Environmental Conditions	
Temperature range	-25°C to +70°C (13°F to 158°F)
Flamability Rating	
Housing	UL 94 V-2

Connection Type	stationary tip
Voltage Rating	fixed socket Ø 2 mm
Measurement Category (IEC61010)	AC/DC 1000V
Current Rating*	CAT III
Contact Resistance	10 A
Material Specifications	20 mOhm
Tip	stainless steel
Connection pin/ socket	gold plated brass
Contact Spring	-
Housing	PA
Environmental Conditions	
Temperature range	-25°C to +70°C (13°F to 158°F)
Flamability Rating	
Housing	UL 94 V-2

Drawing

Measurements are shown in millimeters.
Multiply by 0.03937 to convert to inches.

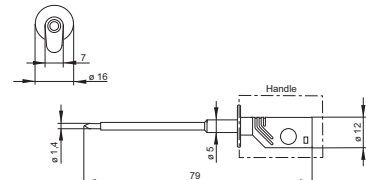
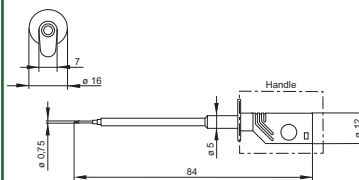
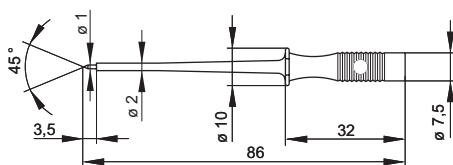

* Please consider derating graph on page 80.

For the latest on Altech Test & Measurement specifications please visit www.altechcorp.com/test-equipment

Test Probes 4 mm System



Type

MZS 1 - PRUEF

Needle-shaped, long stainless steel test probe with shatter-proof insulated sleeve and unsprung 4 mm connecting socket. During state of connection or operation of test leads, it is possible to measure with the test probe from the back side of the closed connector.

Tip diameter

1 mm (0.039 in.)

PART NO. / Housing color

973601100 ●
973601101 ●



PRUEF 2

Test probe with shatter-proof insulated sleeve. Insulation and oxide layers can be penetrated by the slender stainless steel tip. 4 mm diameter brass socket connection. Accessory (optional): tip protector / IC tap SS 260

2 mm (0.079 in.)

973368100 ●
973368101 ●

Technical Data

Connection Type	stationary tip
Voltage Rating	fixed socket Ø 4 mm
Measurement Category (IEC61010)	30 VAC / 60 VDC
Current Rating*	CAT I
Contact Resistance	1 A
Material Specifications	10 mOhm
Tip	stainless steel
Connection pin/ socket	nickel plated brass
Contact Spring	-
Housing	PP
Environmental Conditions	
Temperature range	-20°C to + 60°C (-4°F to 140°F)
Flamability Rating	
Housing	UL 94 HB

stationary tip
fixed socket Ø 4 mm
30 VAC / 60 VDC
CAT I
1 A
50 mOhm
stainless steel
nickel plated brass
-
PP
-25 °C to +80 °C (13°F to 176°F)
UL 94 HB

Drawing

Measurements are shown in millimeters.
Multiply by 0.03937 to convert to inches.

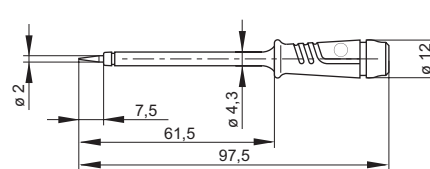
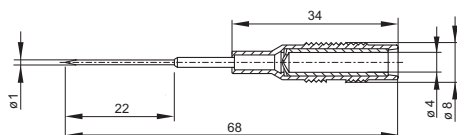

* Please consider derating graph on page 80.

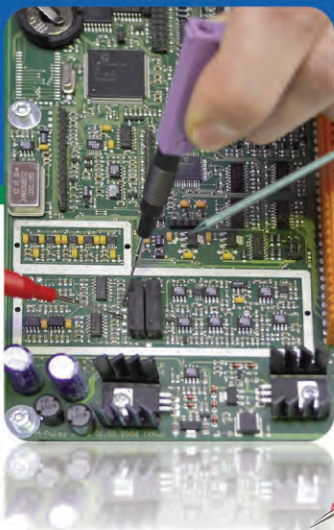

Test Probes 4 mm Safety System



CE



CE



Type

PRUEF 2600 C2

Test probe shatter - proof insulating sleeve and slender stainless steel tip. Tip for penetration of insulation and oxide layers. 4mm diameter brass socket connection. Connection with safety measuring leads. Accessory (optional): protector and IC - tap SS 260

SS 260

Tip protection and IC tap. Clipping onto the PRUEF 2, PRUEF 2 S and PRUEF 2600 C2 test probe covers the needle tip and provides protection against injury. Contact is made with ICs without short circuiting or slipping off.

PRUEF 2610 FT

Test probe with insulated sleeve and slender, sprung stainless steel tip. This allows a constant pressure to be applied without the tip slipping off the component, even in the smallest measuring points. 4 mm diameter brass socket connection.

Tip diameter

2 mm (0.079 in.)

-

0.75 mm (0.029 in.)

PART NO. / Housing color

972327100 ●
972327101 ●

973865001 ○

972318100 ●
972318101 ●

Technical Data

Connection Type	stationary tip
Voltage Rating	fixed socket Ø 4 mm
Measurement Category (IEC61010)	AC/DC 1000V
Current Rating*	CAT II
Contact Resistance	1 A
Material Specifications	50 mOhm
Tip	stainless steel
Connection pin/ socket	nickel plated brass
Contact Spring	-
Housing	PP
Environmental Conditions	
Temperature range	-20°C to +60°C (-4°F to 140°F)
Flamability Rating	
Housing	UL 94 HB

-
-
-
-
-
-
-
-
-
-
-
-

Connection Type	spring-loaded tip
Voltage Rating	fixed socket Ø 4 mm
Measurement Category (IEC61010)	AC/DC 1000 V
Current Rating*	CAT II
Contact Resistance	1 A
Material Specifications	50 mOhm
Tip	stainless steel
Connection pin/ socket	nickel plated brass
Contact Spring	-
Housing	PP
Environmental Conditions	
Temperature range	-25 °C to +80 °C (13°F to 176°F)
Flamability Rating	
Housing	UL 94 HB

Drawing

Measurements are shown in millimeters.
Multiply by 0.03937 to convert to inches.

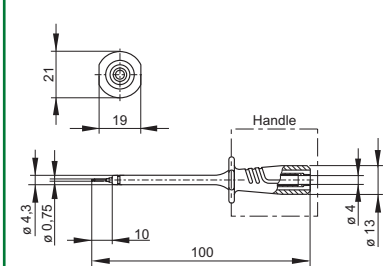
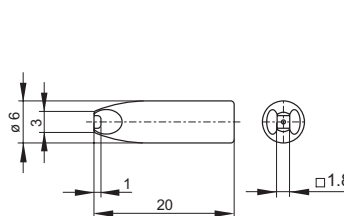
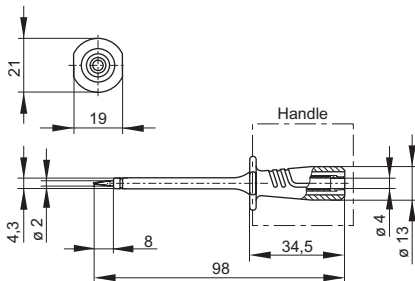

* Please consider derating graph on page 80.

Test Probes 4 mm Safety System



CE

Type

PRUEF 2700

Safety test probe with dual function. Tip for penetrating insulation and oxide layers and 4 mm diameter pin for insertion in sockets. 4 mm diameter brass socket connection. Connects with safety measuring leads.

Tip diameter

4 mm (0.157 in.)

PART NO. / Housing color

972319100 ●
972319101 ●



CE

PRUEF 2600

Test probe with elastic, shatter-proof insulated sleeve and slender stainless steel tip. Tip for penetration of insulation and oxide layers. 4 mm diameter brass socket connection. Connects with safety measuring leads. Accessory tip protector and IC tap SS 260.

2 mm (0.78 in.)

972317100 ●
972317101 ●

Technical Data

Connection Type	stationary tip
Voltage Rating	fixed socket Ø 4 mm
Measurement Category (IEC61010)	AC/DC 1000 V
Current Rating*	CAT II
Contact Resistance	32 A
Material Specifications	2 mOhm
Tip	nickel plated brass
Connection pin/ socket	nickel plated brass
Contact Spring	-
Housing	PP
Environmental Conditions	
Temperature range	-25 °C to +80 °C (13°F to 176°F)
Flamability Rating	
Housing	UL 94 HB

Connection Type	stationary tip
Voltage Rating	fixed socket Ø 4 mm
Measurement Category (IEC61010)	AC/DC 1000 V
Current Rating*	CAT III
Contact Resistance	1 A
Material Specifications	50 mOhm
Tip	stainless steel
Connection pin/ socket	nickel plated brass
Contact Spring	-
Housing	PP
Environmental Conditions	
Temperature range	-25 °C to +80 °C (13°F to 176°F)
Flamability Rating	
Housing	UL 94 HB

Drawing

Measurements are shown in millimeters. Multiply by 0.03937 to convert to inches.

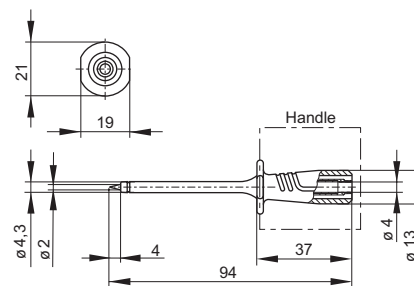
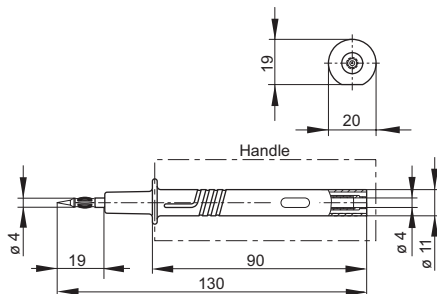

* Please consider derating graph on page 80.